

N Please Refer to North Point and finished Floor Levels in the site Layout Plan (992.PL.005 Rev 0).

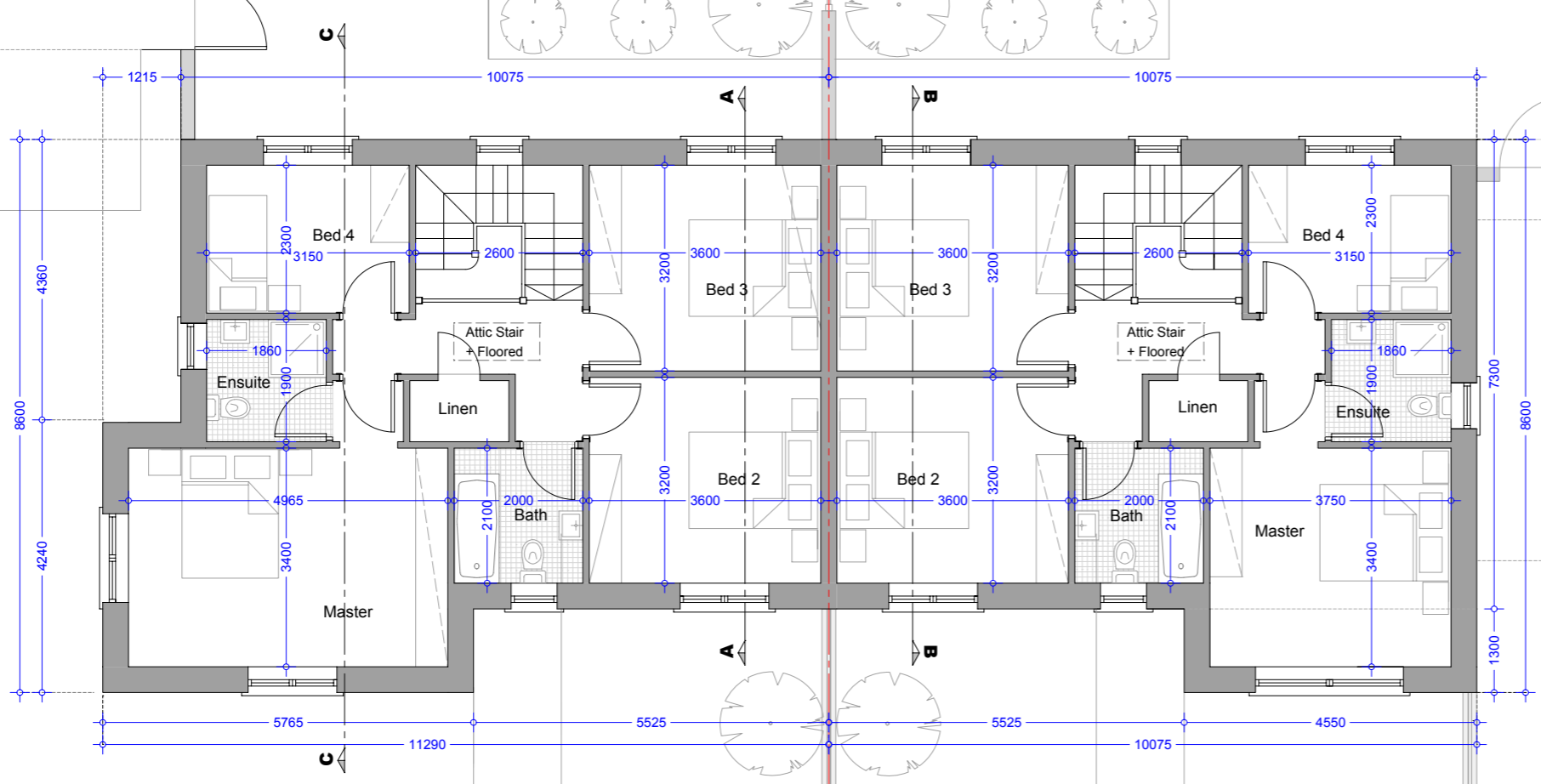

First Floor Plan - House Type B1 - 4Bed Semi (End of Street)
Area = 71.13m² / 765.63 Sqf

First Floor Plan - House Type B - 4Bed Semi (Mid Street)
Area = 66.95m² / 720.64 Sqf

House Type B1 (Semi-Detached)

No.s 10, 11, 120, 121, 133, 139, 247.
No.s 139 & 247 have brick feature bay window, the remainder have stone in lieu.
See Drg. 992.PL.114 & 992.PL.115 for elevation

Type B (Semi Detached)

No.s 1-4 Inclusive
No's 7, 8, 9, 15, 16, 47, 53, 54, 63, 64, 65, 110, 111, 119, 132, 136, 137, 138, 140, 171, 172, 181, 182.
No's 1-4, 7, 8, 9, 132 have stone feature bay window in lieu of brick.
See Drg.992.PL.114 & 992.PL.115 for elevation

House Type B1 - 4Bed Semi

Total House Floor Area = 142.13m² / 1529.73 Sqf

Master Bedroom =	16.88 m ² / 181.69 Sqf
Bedroom 02 =	11.51 m ² / 123.89 Sqf
Bedroom 03 =	11.51 m ² / 123.89 Sqf
Bedroom 04 =	7.25 m ² / 76.20 Sqf

House Type B - 4Bed Semi

Total House Floor Area = 133.90m² / 1441.28 Sqf

Master Bedroom =	13.88 m ² / 149.40 Sqf
Bedroom 02 =	11.51 m ² / 123.89 Sqf
Bedroom 03 =	11.51 m ² / 123.89 Sqf
Bedroom 04 =	7.25 m ² / 76.20 Sqf

House Types B1 & B Storage Areas:

Ground Floor:

Under Stairs Store =	1.5 m ² / 16.1 Sqf
Utility =	4.6 m ² / 49.5 Sqf

First Floor:

Store =	1.4 m ² / 15.0 Sqf
Attic Storage	
(Stira Stair + Floored) =	5.0 m ² / 53.8 Sqf
Total Storage Area =	12.5 m² / 134.5 Sqf

Oldtown, Celbridge, Co. Kildare

House Type B1, B - 4 Bed Semi Detached
First Floor Plan (Mid and End of Street)

Drg. 992.PL.109

Dec 2018

Scale 1:100 @ A3



HOGAN ASSOCIATES