

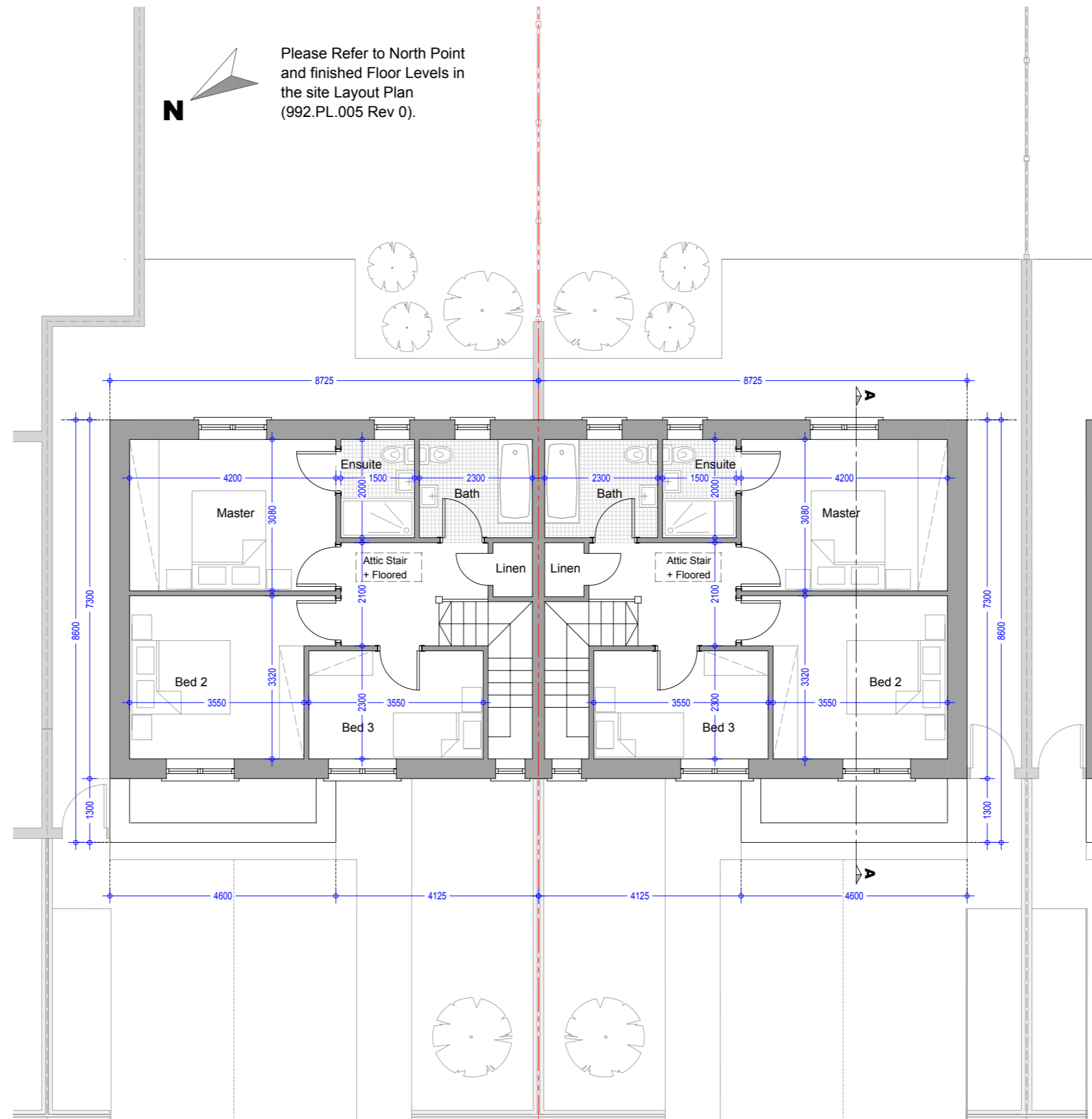

Please Refer to North Point
and finished Floor Levels in
the site Layout Plan
(992.PL.005 Rev 0).



First Floor Plan - House Type C - 3Bed (Mid Street)
Area = 53.29 m² / 573.60 Sqf

First Floor Plan - House Type C - 3Bed (Mid Street)
Area = 53.29 m² / 573.60 Sqf

Type C (Semi Detached)

No's 12, 13, 14, 17, 48, 57, 58, 59, 60, 80, 81, 96, 101,
113, 114, 122, 123, 125, 126, 134, 135, 186, 187.

No's 12, 80, 122, 134, 135 have stone feature bay
window in lieu of brick.

See Drg. 992.PL.134 & 992.PL.135 for elevation

House Type C - 3Bed Semi/Terrace

Total House Floor Area = 111.53 m² / 1200.49 Sqf

Master Bedroom =	13.0 m ² /	133.93 Sqf
Bedroom 02 =	12.44 m ² /	133.90 Sqf
Bedroom 03 =	7.80 m ² /	83.95 Sqf

House Type C - Storage Areas:

Ground Floor:

Utility = 2.76 m² / 29.7 Sqf
Under Stair = 1.35 m² / 14.5 Sqf

First Floor:

Store = 0.7 m² / 7.5 Sqf
Attic Storage
(Stira Stair+Floored) = 5.0 m² / 53.8 Sqf
Total Storage Area = 9.81 m² / 105.5 Sqf

Oldtown, Celbridge, Co. Kildare

House Type C,C - 3 Bed Semi Detached
First Floor Plan (Mid Street)

Drg. 992.PL.149

Dec 2018

Scale 1:100 @ A3



HOGAN ASSOCIATES