

**KEY PLAN**  
Scale NTS

**LEGEND**

- EXISTING ROADWAY
- PROPOSED ROADWAY (DMRA SURFACING)
- PROPOSED 6.0m INTERNAL ROADWAY (TYPE 1)
- PROPOSED 4.0m INTERNAL ROADWAY (TYPE 1)
- PROPOSED 5.5m INTERNAL ROADWAY (TYPE 2)
- PROPOSED 4.0m INTERNAL ROADWAY (TYPE 2)
- PROPOSED 5.0m INTERNAL ROADWAY (TYPE 3)

NOTE:  
PROPOSED INTERNAL ROADS REDUCED TO 4.0m TO CREATE A HORIZONTAL DEFLECTION TO ENCOURAGE LOWER SPEEDS

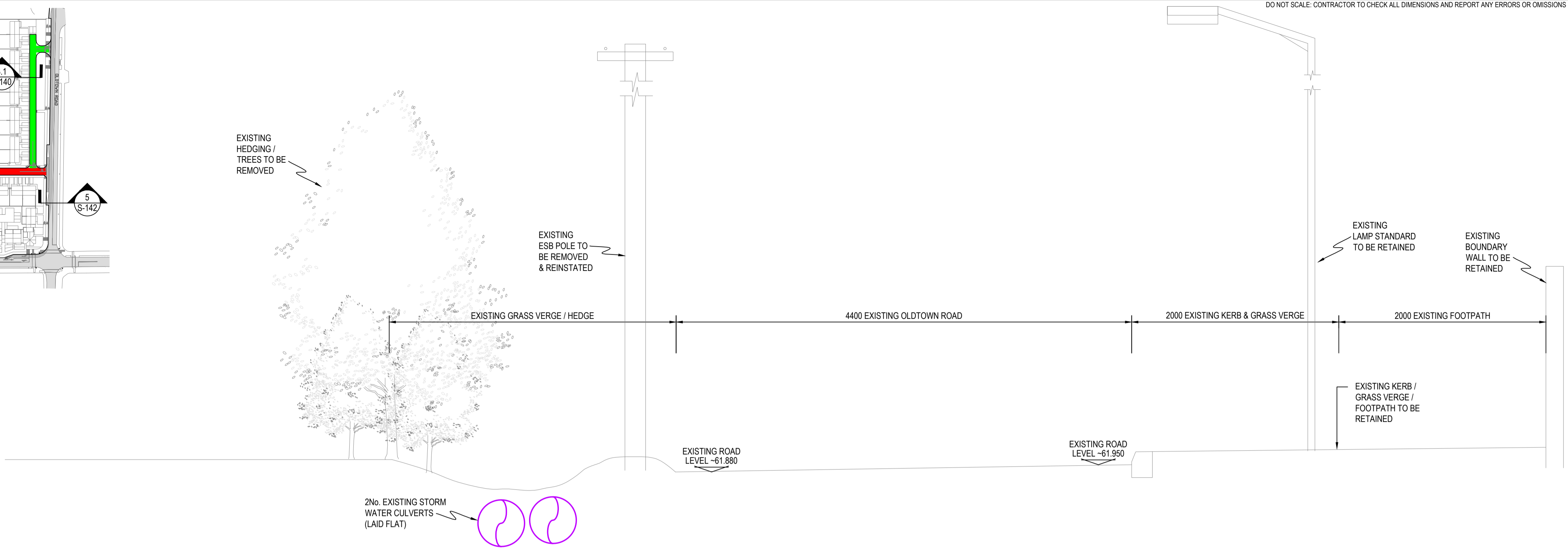

**SECTION 5a - OLDTOWN ROAD (EXISTING)**  
SCALE: 1:25

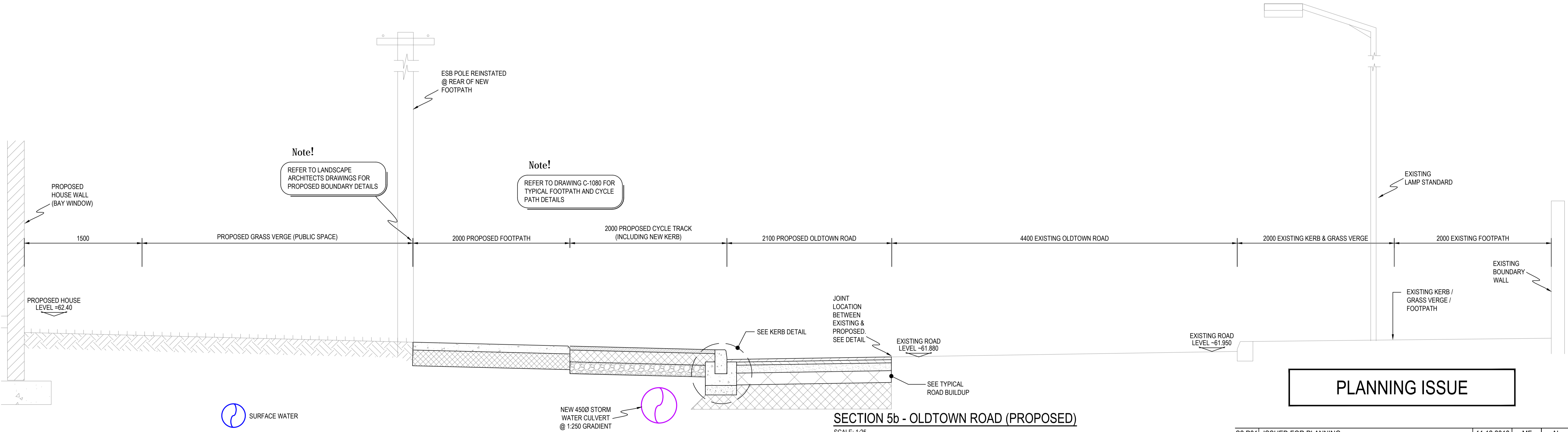

**SECTION 5b - OLDTOWN ROAD (PROPOSED)**  
SCALE: 1:25

**PLANNING ISSUE**

S2.P01	ISSUED FOR PLANNING	11.12.2018	MF	AL
Rev.	Note	Date	Drawn	Check
<p><b>DONNACHADH O'BRIEN &amp; ASSOCIATES CONSULTING ENGINEERS</b></p>		<p>UNIT 5C ELM HOUSE MILLENNIUM PARK NAAS CO. KILDARE</p>		<p>PHONE +353 45 984 042</p> <p>INFO@DOBRIEN-ENGINEERS.IE WWW.DOBRIEN-ENGINEERS.IE</p>
Client: O'FLYNN CONSTRUCTION CO. UNLIMITED COMPANY				
Project: OLDTOWN ROAD, CELBRIDGE				
Drawing Title: PROPOSED ROAD TYPE G.A. & DETAILS SHT 3 OF 3				
Drawn By: MF	Checked By: AL	Approved By: DOB	Date: NOV' 18	Scale: 1:25
Project Number: DOBA1704	Drawing Number: OLDCEL-DOB- 00-SI- DR-C-142	Status Code: S2	Rev Number: P01	