

NOTES:

1. REFER TO ARCHITECTS DRAWINGS FOR ALL SITE & APPLICATION BOUNDARIES
2. THIS DRAWING IS TO BE READ IN CONJUNCTION WITH ALL OTHER RELEVANT ARCHITECT'S & ENGINEER'S DRAWINGS AND SPECIFICATIONS.
3. USE FIGURED DIMENSIONS ONLY. DO NOT SCALE
4. REFER TO SURVEY DRAWINGS FOR EXISTING SERVICES LAYOUTS AND MANHOLE INFORMATION
5. ALL EXISTING SURFACES TO BE REINSTATED FOLLOWING DIVERSION OF SERVICES/CONSTRUCTION OF NEW SERVICES
6. THE CONTRACTOR SHALL VERIFY ALL DIMENSIONS AND LEVELS WITH ARCHITECTURAL DRAWINGS PRIOR TO START OF CONSTRUCTION. ANY DISCREPANCIES TO BE NOTIFIED TO THE ENGINEER & ARCHITECT FOR RESOLUTION
7. CONTRACTOR TO ENSURE ALL WATER & WASTEWATER RELATED WORKS ARE IN ACCORDANCE WITH THE IRISH WATER WATER INFRASTRUCTURE & WASTEWATER INFRASTRUCTURE CODE OF PRACTICE & STANDARD DETAILS DOCUMENTS
8. TESTING OF ALL GRAVITY SEWERS AND MANHOLES TO BE IN ACCORDANCE WITH IRISH WATER CODE OF PRACTICE FOR WASTEWATER INFRASTRUCTURE SECTION 4.10 TESTING OF GRAVITY SEWERS & MANHOLES



FOR PROPOSED ROAD MARKINGS & SIGNAGE TO TRANSITION ZONE & BUS STOP REFER TO DRAWING C-065 DETAIL 1

FOR PROPOSED ROAD MARKINGS & SIGNAGE TO SITE ENTRANCE ONTO SHACKLETON ROAD REFER TO DRAWING C-065 DETAIL 2

LS - INDICATES EXISTING LAMP STANDARD TO BE MOVED TO THE BACK OF THE PROPOSED NEW FOOTPATH (TYP)

EXISTING CYCLE LAND AND FOOTPATH TO BE INTO PROPOSED

PROPOSED TOUCAN PEDESTRIAN CROSSING WITH TACTILE PAVING

EXISTING ROAD MARKINGS TO BE RETAINED

PROPOSED RAISED TABLETOP CROSSING AT SITE ENTRANCE ONTO SHACKLETON RD

!NOTE
FOR DESCRIPTIONS OF ROAD MARKINGS & ROAD SIGNS REFER TO TABLES ON DRAWING C-061

PLANNING ISSUE

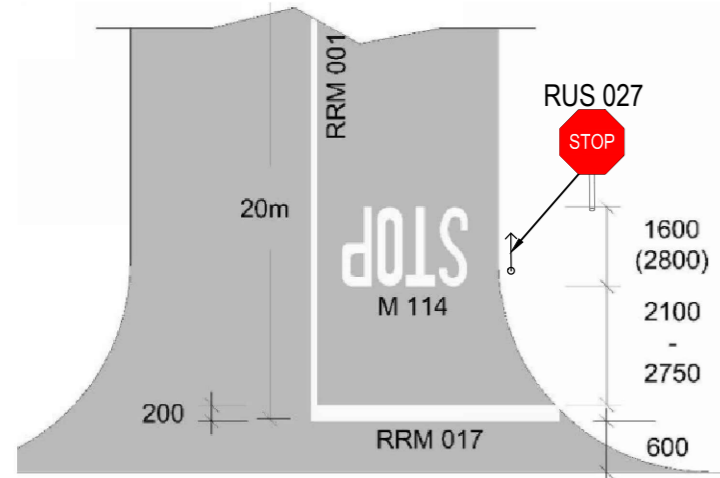

Figure 7.35: Example of Priority-Controlled Stop Junction
Note: See Paragraph 7.11.2

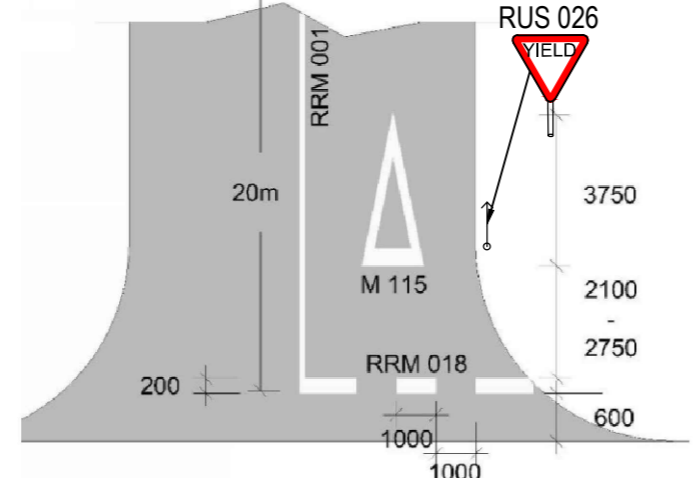
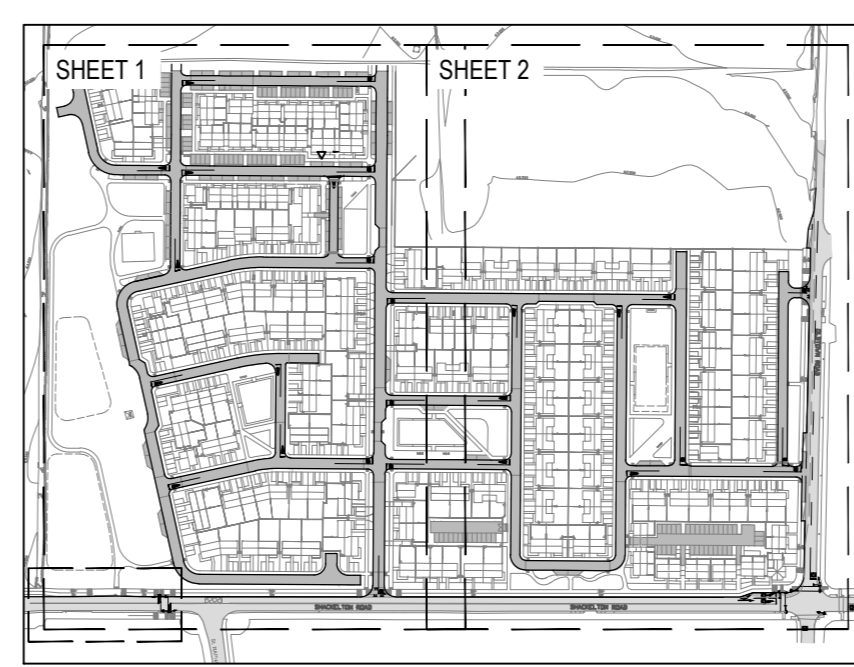

Figure 7.36: Example of Priority-Controlled Yield Junction
Note: See Paragraph 7.11.2



KEY PLAN
Scale NTS

S2.P01	ISSUED FOR PLANNING	11.12.2018	KD	AL
Rev.	Note	Date	Drawn	Check
DONNACHADH O'BRIEN & ASSOCIATES CONSULTING ENGINEERS		UNIT 5C ELM HOUSE MILLENNIUM PARK NAAS CO. KILDARE		PHONE +353 45 984 042 INFO@DOBRIEN-ENGINEERS.IE WWW.DOBRIEN-ENGINEERS.IE
Client:		O'FLYNN CONSTRUCTION CO. UNLIMITED COMPANY		
Project:		OLDTOWN ROAD, CELBRIDGE		
Drawing Title:		PROPOSED SITE ROAD MARKINGS & SIGNAGE - SHEET 1 OF 2		
Drawn By:	Checked By:	Approved By:	Date:	Scale:
MF	AL	DOB	NOV'18	1:500
Project Number:	Drawing Number:	Status Code:	Rev Number:	
DOBA1704	OLDCEL-DOB-00-SI-DR-C-060	S2	P01	

TYPICAL JUNCTION DETAILS (FROM TRAFFIC SIGNS MANUAL)

SCALE (NTS)