

TABLE OF ROAD MARKINGS

| SIGN NUMBER | DESCRIPTION | NOTES |
|-------------|-----------------------------------|--|
| RRM 001 | CONTINUOUS SINGLE CENTRE LINE | WHITE, CONTINUOUS LINE, 100mm WIDE |
| RRM 002B | BROKEN ROAD CENTRE LINE | WHITE, 3000mm LINE, 3000mm GAP, 150mm WIDE |
| RRM 011 | PARKING BAYS | WHITE, CONTINUOUS LINE, 100mm WIDE |
| RRM 017 | STOP LINE | WHITE, CONTINUOUS LINE, 200mm WIDE |
| RRM 018 | YIELD LINE | WHITE, 500mm LINE, 500mm GAP, 200mm WIDE |
| RRM 018C | CYCLE TRACK - YIELD LINE | WHITE, 300mm LINE, 300mm GAP, 100mm WIDE |
| RRM 022 | EDGE OF CYCLE TRACK | WHITE, CONTINUOUS LINE, 100mm WIDE |
| RRM 023 | EDGE OF CYCLE TRACK - BROKEN LINE | WHITE, 750mm LINE, 750mm GAP, 100mm WIDE |
| RRM 005 | DIRECTIONAL ARROW - LEFT | WHITE, 3.6m LONG |
| M 102 | BIFURCATION ARROWS - AHEAD & LEFT | WHITE, 8m LONG |
| M 111 | PEDESTRAIN MARKING | WHITE |
| M 114 | STOP WORDED MARKING | WHITE, 1.6m LONG LETTERING |
| M 115 | TRIANGULAR YIELD MARKING | WHITE, 3.75m LONG |
| M 116 | CYCLE PATH MARKING | WHITE |
| M 125 | DIRECTIONAL ARROW - AHEAD & RIGHT | WHITE, 3.6m LONG |

TABLE OF ROAD SIGNS

| SIGN NUMBER | DESCRIPTION | NOTES |
|-------------|--|------------------------------|
| RUS 026 | YIELD | 600mm WIDE SIGN |
| RUS 027 | STOP | 600mm WIDE SIGN |
| RUS 058CR | SEGREGATED CYCLE & PEDESTRIAN ROUTE (CYCLE ON RIGHT) | 600mm WIDE SIGN |
| RUS 058 | SHARED TRACK, CYCLE /PEDESTRIAN | 600mm WIDE SIGN |
| RUS 044 | SPEED LIMIT SIGN, 30 KM/H | 600mm WIDE SIGN |
| F 403 | SPEED ZONE SIGN, 30 KM/H, CHILDREN AT PLAY | 550mm WIDE, 1210mm HIGH SIGN |
| RUS 004 | KEEP STRAIGHT AHEAD | 600mm WIDE SIGN |
| RUS 050 | NO ENTRY SIGN | 600mm WIDE SIGN |

NOTE:
ALL ROAD MARKINGS TO BE IN ACCORDANCE WITH THE DEPARTMENT OF TRANSPORT TRAFFIC SIGNS MANUAL CHAPTER 7 - ROAD MARKINGS

NOTES:

- REFER TO ARCHITECTS DRAWINGS FOR ALL SITE & APPLICATION BOUNDARIES
- THIS DRAWING IS TO BE READ IN CONJUNCTION WITH ALL OTHER RELEVANT ARCHITECT'S & ENGINEER'S DRAWINGS AND SPECIFICATIONS.
- USE FIGURED DIMENSIONS ONLY. DO NOT SCALE
- REFER TO SURVEY DRAWINGS FOR EXISTING SERVICES LAYOUTS AND MANHOLE INFORMATION
- ALL EXISTING SURFACES TO BE REINSTATED FOLLOWING DIVERSION OF SERVICES/CONSTRUCTION OF NEW SERVICES
- THE CONTRACTOR SHALL VERIFY ALL DIMENSIONS AND LEVELS WITH ARCHITECTURAL DRAWINGS PRIOR TO START OF CONSTRUCTION. ANY DISCREPANCIES TO BE NOTIFIED TO THE ENGINEER & ARCHITECT FOR RESOLUTION
- CONTRACTOR TO ENSURE ALL WATER & WASTEWATER RELATED WORKS ARE IN ACCORDANCE WITH THE IRISH WATER WATER INFRASTRUCTURE & WASTEWATER INFRASTRUCTURE CODE OF PRACTICE & STANDARD DETAILS DOCUMENTS
- TESTING OF ALL GRAVITY SEWERS AND MANHOLES TO BE IN ACCORDANCE WITH IRISH WATER CODE OF PRACTICE FOR WASTEWATER INFRASTRUCTURE SECTION 4.10 TESTING OF GRAVITY SEWERS & MANHOLES

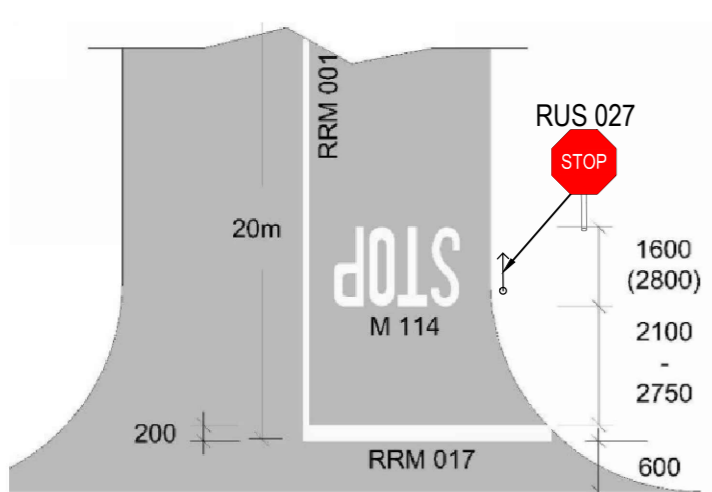
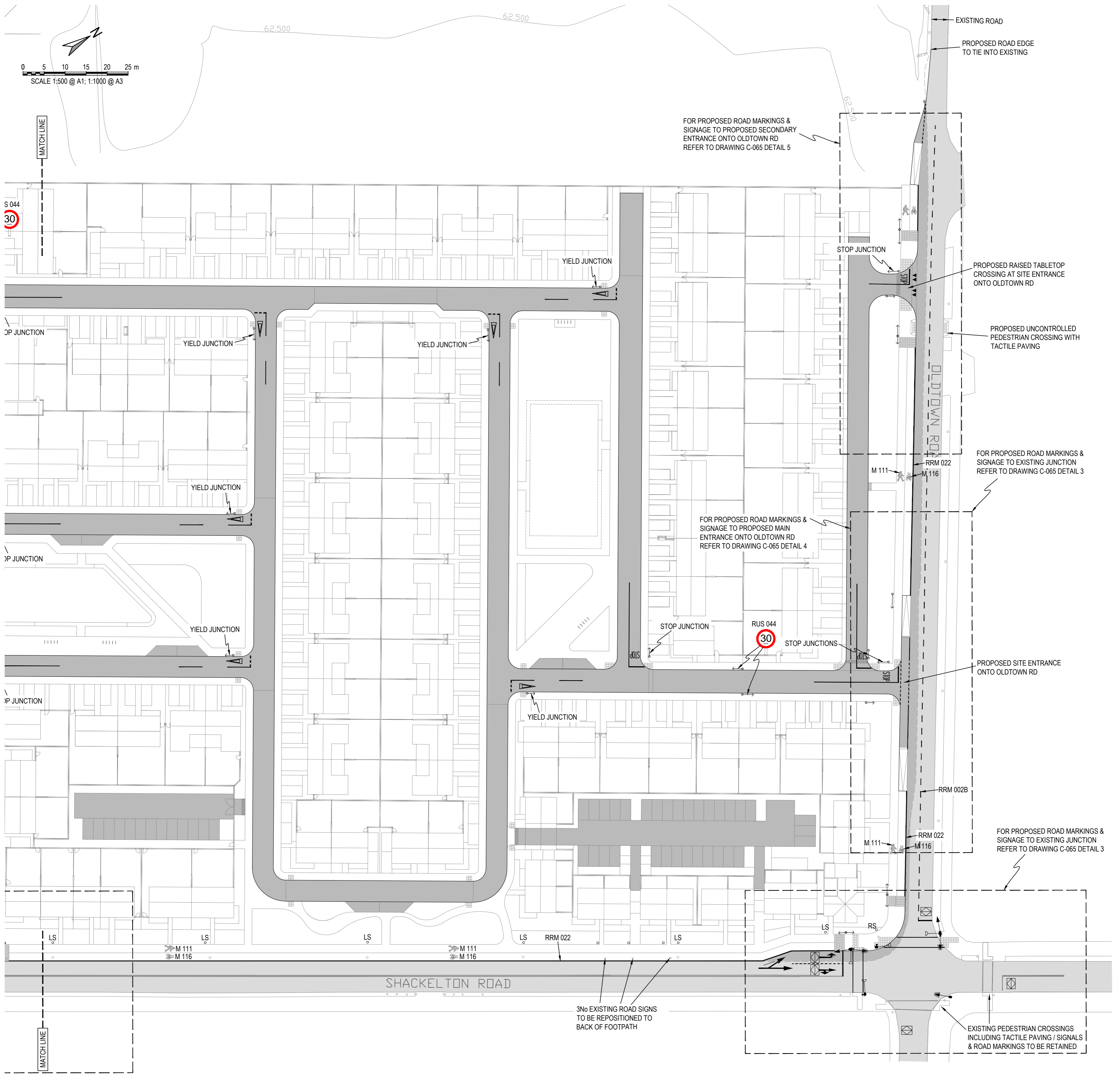

Figure 7.35: Example of Priority-Controlled Stop Junction
Note: See Paragraph 7.11.2

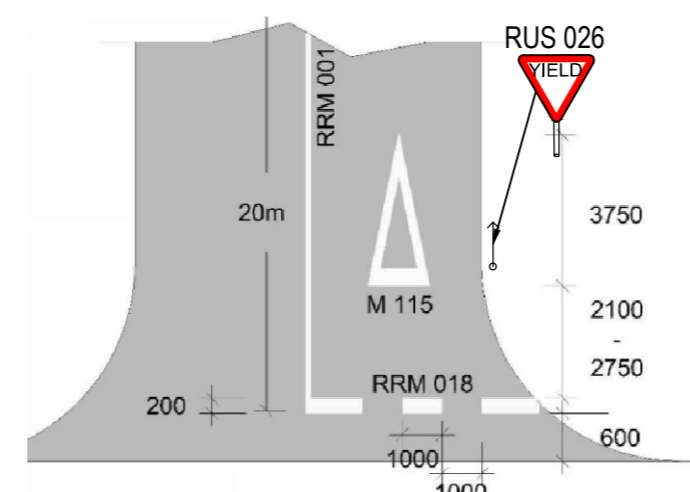
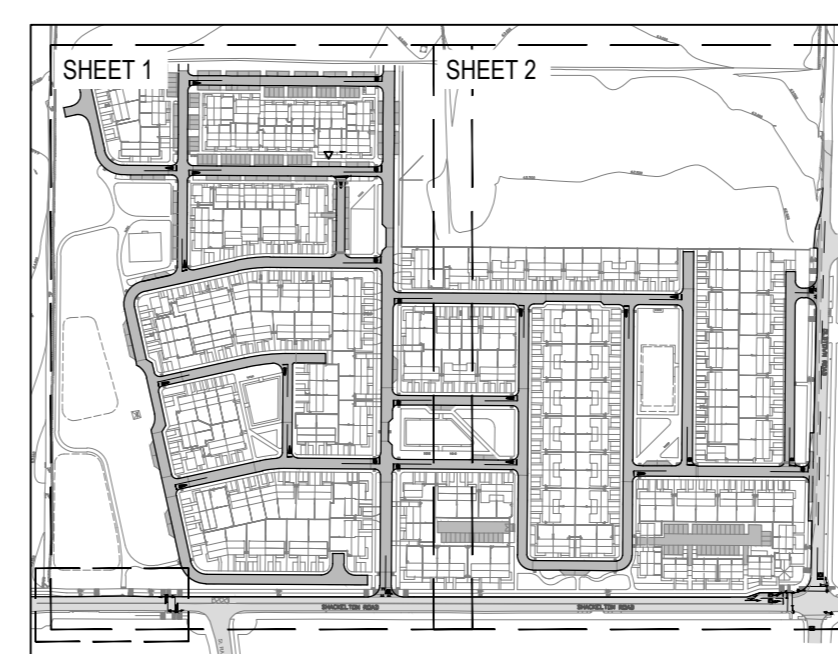

Figure 7.36: Example of Priority-Controlled Yield Junction
Note: See Paragraph 7.11.2

TYPICAL JUNCTION DETAILS (FROM TRAFFIC SIGNS MANUAL)

SCALE (NTS)



KEY PLAN
Scale NTS

PLANNING ISSUE

| | | | | |
|---|---------------------|--|--------------|---|
| S2.P01 | ISSUED FOR PLANNING | 11.12.2018 | MF | AL |
| Rev. | Note | Date | Drawn | Check |
| DONNACHADH O'BRIEN & ASSOCIATES CONSULTING ENGINEERS | | UNIT 5C ELM HOUSE MILLENNIUM PARK NAAS CO. KILDARE | | PHONE +353 45 984 042 INFO@DOBRIEN-ENGINEERS.IE WWW.DOBRIEN-ENGINEERS.IE |
| Client: O'FLYNN CONSTRUCTION CO. UNLIMITED COMPANY | | | | |
| Project: OLDTOWN ROAD, CELBRIDGE | | | | |
| Drawing Title: PROPOSED SITE ROAD MARKINGS & SIGNAGE - SHEET 2 OF 2 | | | | |
| Drawn By: MF | Checked By: AL | Approved By: DOB | Date: NOV'18 | Scale: 1:500 |
| Project Number: DOBA1704 | | Drawing Number: OLDCEL-DOB-00-SI-DR-C-061 | | Status Code: S2 |
| | | | | Rev Number: P01 |